

1.7 - Find Perimeter, Circumference, and Area

Perimeter: the distance around a figure

Circumference: the distance around a circle

Area: the amount of surface covered by a figure

Note: Perimeter and Circumference are measured in units of length and area is measured in square units.

Square

$$P = 4s$$

$$A = s^2$$

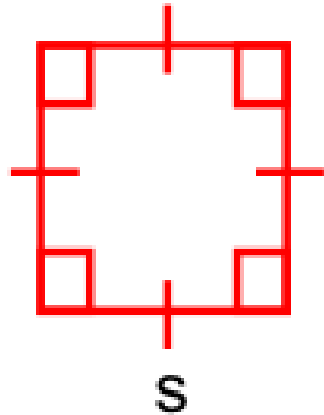

Rectangle

$$P = 2w + 2l$$

$$A = l \times w$$

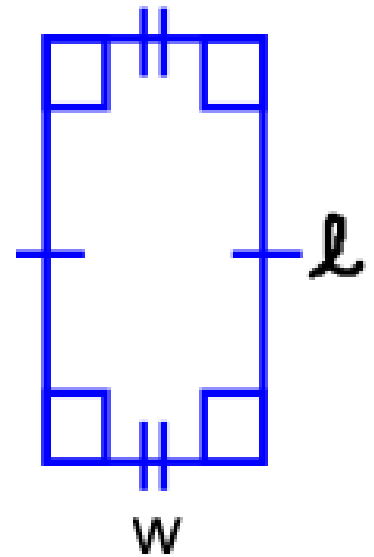

Triangle

$$P = a + b + c$$

$$A = \frac{b \cdot h}{2}$$

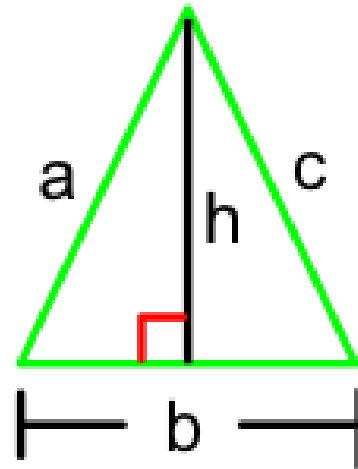

Circle

$$C = \pi d$$

or

$$2\pi r$$
$$A = \pi r^2$$

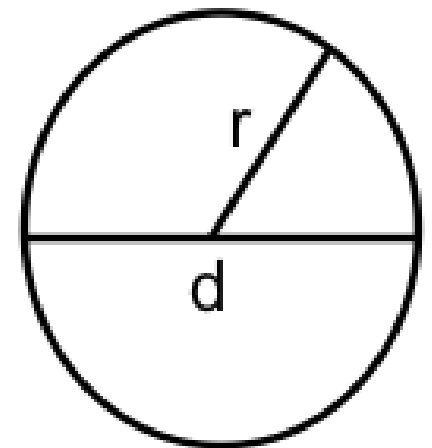

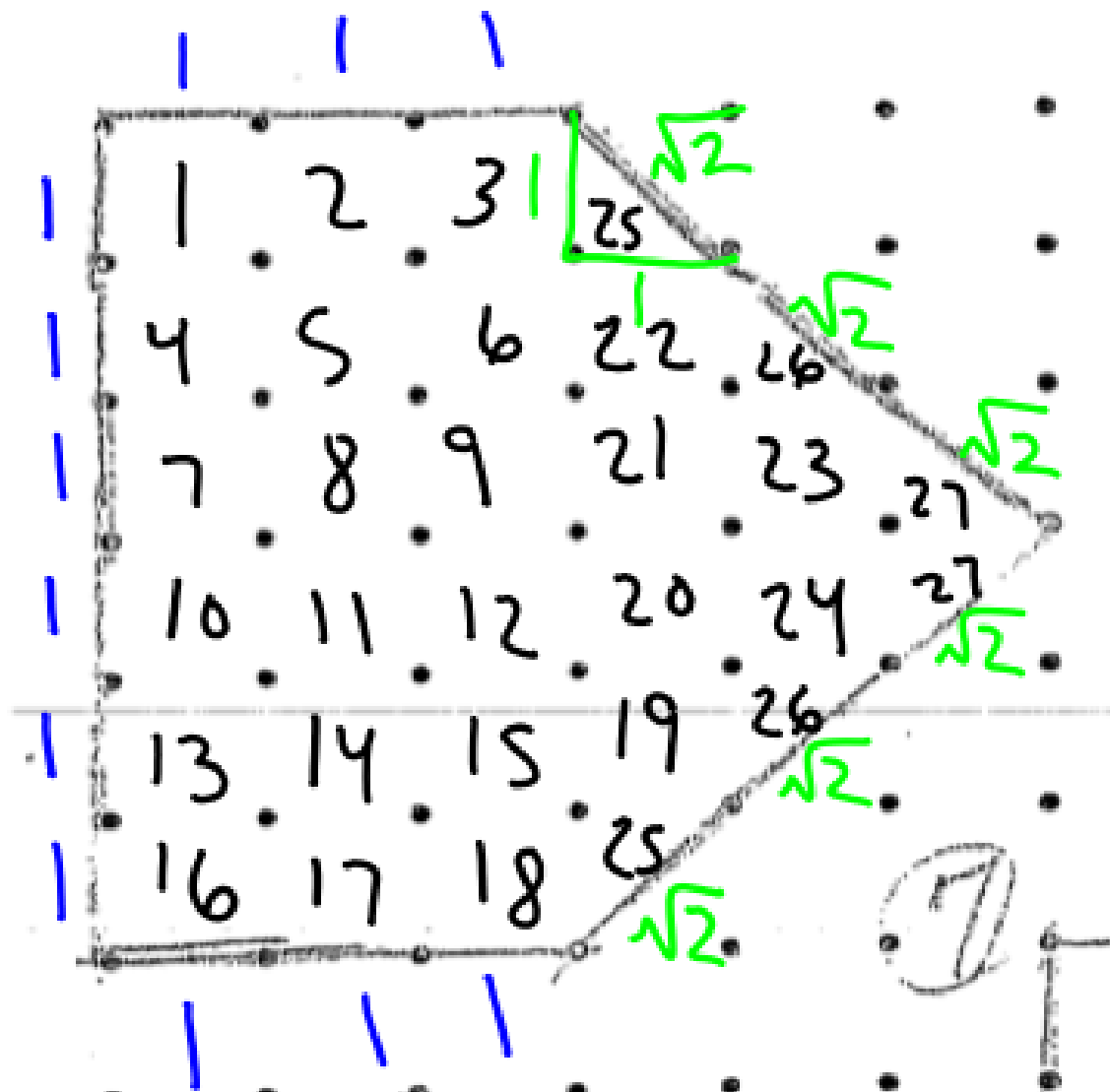

$$P = 12 + 6\sqrt{2} \text{ units} \quad A = 27 \text{ units}^2$$

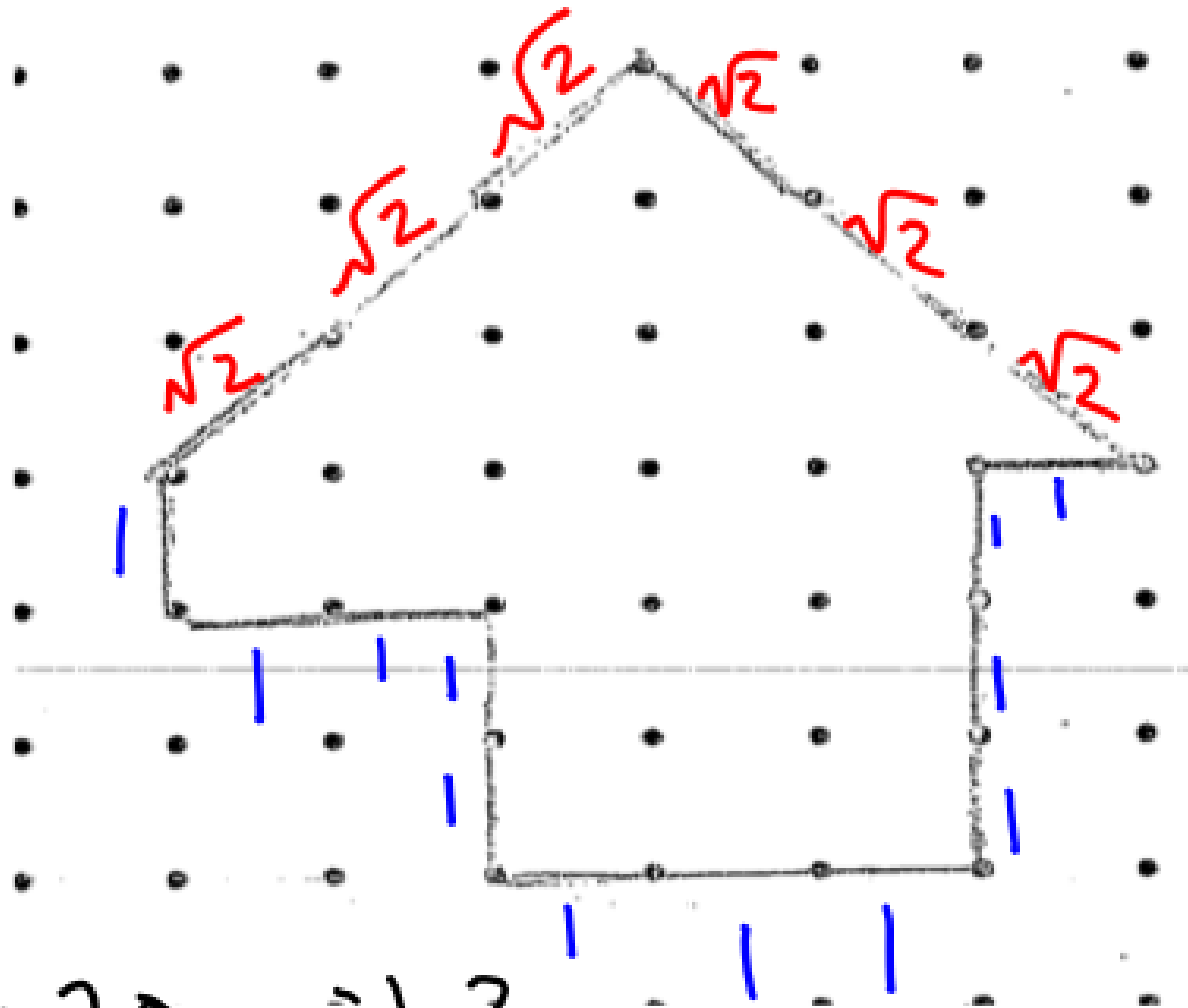

$$A = 20 \text{ units}^2$$

$$P = 12 + 6\sqrt{2} \text{ units}$$

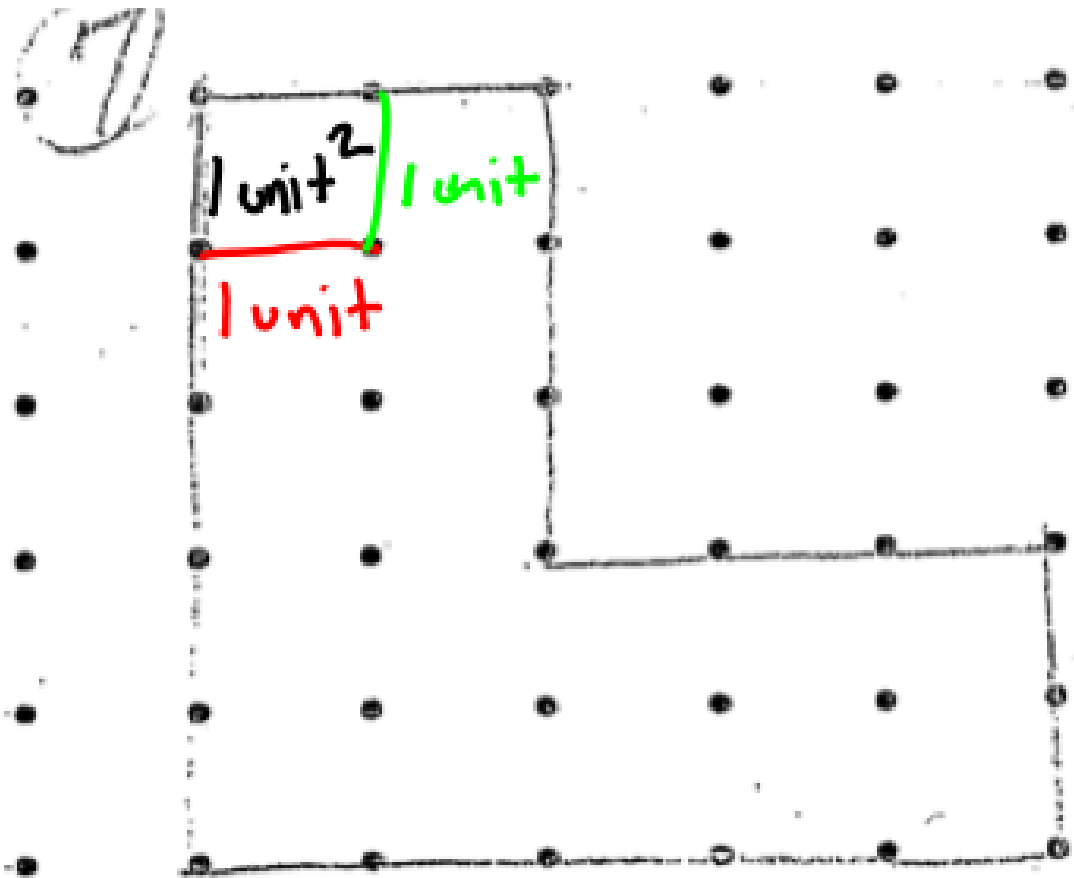

$$P = 20 \text{ units}$$
$$A = 16 \text{ units}^2$$

Homework: Extra Practice 1.7 #1-7 all